

VP700E(I)LCD/VP1000E(I)LCD
VP1200E(I)LCD/VP1600E(I)LCD

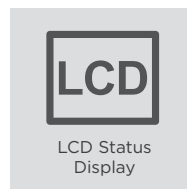

TOWER UPS WITH LCD DISPLAY FOR PROFESSIONAL USAGES

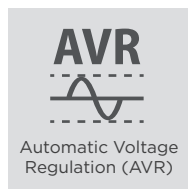
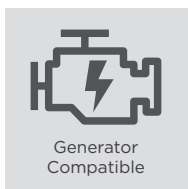
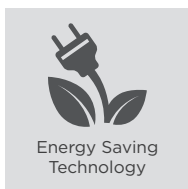

The GreenPower UPS providing reliable battery backup and data line protection with high-speed transmission for home and office

Ideal for home, office and back office applications, the Value Pro Series adopts line-interactive topology with Automatic Voltage Regulation (AVR) function to offer stabilized AC power output. The products provide multifunctional LCD readout to display clear power and battery conditions. The data line protection with high-speed transmission safeguards phones, network and communication equipment against surge/spike as well as supply 1Gbps speed to transmit data. The products' power management software achieves real-time monitoring and configuration.

SERIES FEATURES

- Line-interactive UPS Topology
- Energy Saving Technology
- Generator Compatible
- Simulated Sine Wave Output
- Automatic Voltage Regulation (AVR)
- LCD Status Display
- High-Speed Ethernet Data Transmission
- USB Connectivity Port
- Surge and Spike Protection
- Serial Connectivity Port
- PowerPanel® Management Software

PRODUCT CALLOUTS

1. Power On Indicator
2. Power On/Off Switch
3. LCD Display Panel
4. Function Button(s)
5. Battery Backup & Surge Protected Outlets
6. Communication Protection Ports RJ11/RJ45

7. Input Circuit Breaker
8. AC Inlet
9. USB Port
10. Serial Port
11. Surge Protected Outlet(s)

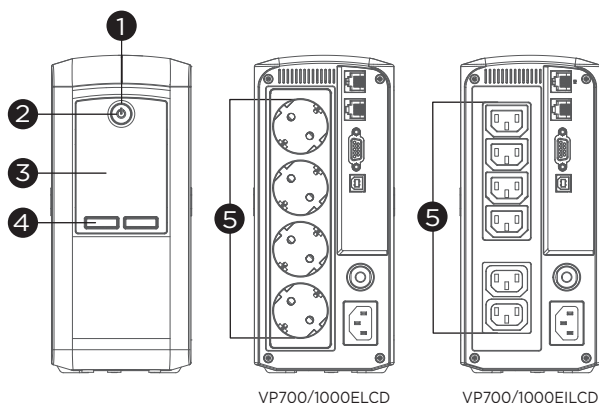

VP700/1000E(L)CD

VP700/1000E(L)CD

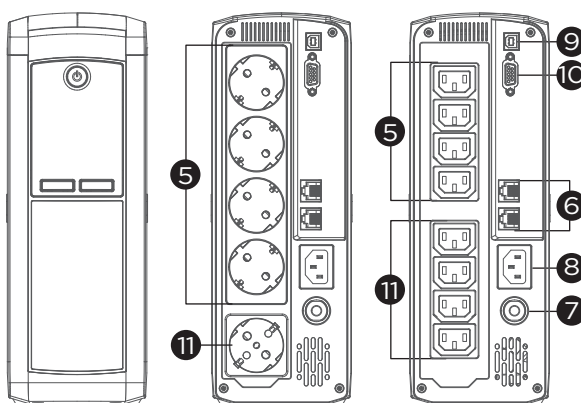

VP1200/1600E(L)CD

VP1200/1600E(L)CD





TECHNICAL SPECIFICATIONS

Model Name	VP700E(I)LCD	VP1000E(I)LCD	VP1200E(I)LCD	VP1600E(I)LCD
General				
UPS Topology	Line-interactive			
Energy Saving Technology	GreenPower UPS™ Bypass Technology			
Input				
Nominal Input Voltage (Vac)	230 ± 10%			
Input Voltage Range (Vac)	167 - 295			
Input Frequency (Hz)	50 ± 5, 60 ± 5			
Rated Input Current (A)	3.04	4.35	5.2	6.96
Input Connector Type	IEC C14			
Output				
Capacity (VA)	700	1000	1200	1600
Capacity (Watts)	390	550	720	960
On Battery Waveform	Simulated Sine Wave			
On Battery Voltage(s) (Vac)	230 ± 10%			
On Battery Frequency (Hz)	50 ± 1%, 60 ± 1%			
Automatic Voltage Regulation (AVR)	Single Boost, Single Buck			
Overload Protection	Circuit Breaker			
Outlet(s) - Total	4 [Schuko/FR] or 6 [IEC]		5 [Schuko/FR] or 8 [IEC]	
Outlet Type	Schuko x 4 or FR x 4 or IEC x 6		Schuko x 5 or FR x 5 or IEC x 8	
Outlet(s) - Battery & Surge Protected	4 [Schuko/FR] or 6 [IEC]		4 [Schuko/FR] or 4 [IEC]	
Outlet(s) - Surge-Only Protected	-		1 [Schuko/FR] or 4 [IEC]	
Typical Transfer Time (ms)	4			
Battery				
Runtime at Half Load (min)	10	9	12	11
Runtime at Full Load (min)	1		4	2
Typical Recharge Time (Hours)	8			
User-replaceable	Yes - Qualified Personnel Only			
Battery Type	Sealed Lead-acid			
Surge Protection & Filtering				
Surge Suppression (Joules)	450			
EMI/RFI Filtration	Yes			
Phone/Network Protection RJ11/RJ45 (Combo)	1-in, 1-out			
Management & Communications				
LCD Panel	Yes			
LED Indicators	Power On			
HID Compliant USB Port(s)	1			
Serial Port	RS232			
Audible Alarms	Battery Mode, Low Battery, Overload, UPS Fault			
Power Management Software	PowerPanel® Personal (Recommended)			
Physical				
Form Factor	Tower			
Physical Size - UPS Module				
Dimensions (WxHxD) (mm.)	100 x 227 x 260		100 x 281 x 355	
Weight (kg.)	5.14	6.23	9.62	10.42
Environmental				
Operating Temperature (°C)	0 - 40			
Operating Relative Humidity (Non-condensing) (%)	0 - 90			
Online Thermal Dissipation (BTU/hr)	9.5	23.9	74	68
Certifications				
Certifications*	CE, EAC			
RoHS	Yes			

*Certifications may vary according to different regions. Visit www.cyberpower.com for more information.
#All specifications are subject to change without notice.